



GRIER MEADOWS

WEEK OF JANUARY 27, 2025



CAPITAL LAND
PARTNERS

WEEK OF JANUARY 27

WORK SUMMARY

- Street trees and sod were installed in phase 2 and along Frank Grier Rd. The planting strip in front of BMP 3 was fine graded and sodded, and the common area landscaping is now complete in phase 1. We are pressing to get the phase 1 storm pipe video approved and the repair work completed so we can schedule the punchout work and obtain the bond release for this phase.
- Abernethy fine graded lot 80 in phase 3, and fixed the damaged water valves beside lot 55 in phase 2. They also installed the remaining conduit crossing for Duke in phase 4. Duke is expected to complete their install in phase 4 the week of 2/3. AT&T is scheduled to complete phase 4 install the week of 2/10.
- The Grier's sewer service applications and executed sewer easement were sent to the City, and they are reviewing the easement. Once approved, we can submit payment, and the City will schedule the work.



PLAT CHECKLIST

	Roadway Paving	Utility Testing	Sewer/Water As-Builts	Storm As-Builts	Storm Video
Phase 1	Complete	Complete	Approved	Approved	Under Review
Phase 2	Complete	Complete	Approved	Approved	Under Review
Phase 3	Complete	Complete	Approved	In Progress	Under Review
Phase 4	Complete	Complete	Approved	In Progress	Under Review

UTILITY INSTALLATION PROGRESS

	Sewer	Water	Storm
Phase 1	Complete	Complete	Complete
Phase 2	Complete	Complete	Complete
Phase 3	Complete	Complete	Complete
Phase 4	Complete	Complete	Complete



UTILITY PROGRESS

FORESTRY
BERNARD J. JONES
1000 FOREST DR
TAX PARCEL 10816512

Henry Grier
Alfred Gypsy
1000 FOREST DR
TAX PARCEL 10816512

PRE-CONSTRUCTION MEETING
PRIOR TO ANY LAND
ACTIVITY USING THE ONLINE TP
TP: <http://charlottenc.gov/ld>

GRIER
RETH
102
11201

DEXTER GRIER
8 6991 PG 810
PARCEL 10811225

POST CONSTRUCTION
CONTROLS EASEMENT (TYP.)

JAMES DAVID GRIER
DB 4507 PG 491
TAX PARCEL 10811205

JAMES D GRIER
INEZ M GRIER
DB 2342 PG 430
TAX PARCEL 10811207

THOMAS B BYNUM
KATIE W BYNUM
DB 4248 PG 58
TAX PARCEL 10811223

BETTY BYNUM OWENS

WAYNE ALLEN SCHE
ROBERTSON PG 226
TAX PARCEL 10816512

DEMETRIA A WALKER
DB 8748 PG 47
TAX PARCEL 10816512

JOHN W WATTS
AGNES W WATTS
DB 1545 PG 40
TAX PARCEL 10816512

WENDELL BALI
DORIS BALI
DB 8748 PG 47
TAX PARCEL 10816512

DAVID F
BEAU
DB
THAT

JOHN F ALL
CHARLES W
DB 8722 PG 4
TAX PARCEL 10816512

ROBERT REYNOLDS
LAWRENCE REYNOLDS
DB 8748 PG 47
TAX PARCEL 10816512

JOHANNES JR JONES
GAIL JONES
DB 8748 PG 47
TAX PARCEL 10816512

RELIUS W WATTS
DB 8748 PG 47
TAX PARCEL 10816512

PROGRESS RESIDENTIAL
BOBROWELL
DB 3006 PG 6
TAX PARCEL 10816512

DAVID GURBAUD
TAX PARCEL 10816512

CARLENE MARTIN
TAX PARCEL 10816512

FRANK GRIER
DB 2525 PG 5
TAX PARCEL 10816512

WILLIAM OWENS
LISHA OWENS
DB 8748 PG 47
TAX PARCEL 10816512

JOHN P ALEXANDER
DEBBIE ALEXANDER
DB 8748 PG 47
TAX PARCEL 10816512

WILLIAM OWENS
DB 2525 PG 5
TAX PARCEL 10816512

PRISCILLA OWENS
DB 1882 PG 29
TAX PARCEL 10816512

GRADY B BOWENS
BROWN W THOMPSON
TAX PARCEL 10816512

MARTHA C SLOAN-CL
DB 8558 PG 38
TAX PARCEL 10816512

GLADY T HORN
DB 8812 PG 6
TAX PARCEL 10816512

ADELA B LEVI
DB 3118 PG 423
TAX PARCEL 10816524



LEGEND

	TREE SAVE
	SIDEWALKS
	WETLANDS
	PROPOSED SEW
	DI
	DP
	CB
	CATCH BASIN
	REINFORCED CC

UTILITY NOTES:

- CONSTRUCTION AND MATERIALS SHALL BE IN ACCORDANCE WITH CHARLOTTE WATER STANDARDS AND SPECIFICATIONS PER WEBSITE AT WWW.CHARLOTTEWATER.ORG.
- DUCTILE IRON PIPE (RED BRASS FOR 2" WATER PIPES) REQUIRED FOR BOTH WATER AND SANITARY SEWER LINES IF THE FOLLOWING CLEARANCES ARE NOT MET:

ROADWAY PROGRESS

	Curb/Stone	First Lift	Final Lift
Phase 1	Complete	Complete	Incomplete
Phase 2	Complete	Complete	Incomplete
Phase 3	Complete	Complete	Incomplete
Phase 4	Complete	Complete	Incomplete



DRY UTILITY PROGRESS

	Duke Energy	Spectrum	AT&T	PNG
Phase 1	Complete	Complete	Complete	Complete
Phase 2	Complete	Complete	Complete	Complete
Phase 3	2/6 start date	Spectrum will install after Duke.	AT&T will install after Duke.	PNG will install after Duke.
Phase 4	In Progress. To be completed the week of 2/3.	Complete	AT&T will install after Duke. To be completed the week of 2/10.	Complete

DRY UTILITY PROGRESS

CONSTRUCTION CONTROL
AN FORESTRY
 INCHANCE
 T

CHEDULE PRE-CONSTRUCTION MEETING
 48 HRS. PRIOR TO ANY LAND
 GING ACTIVITY USING THE ONLINE
 ND AT <http://charlottesville.gov/ld>

Gina Hodges
Henry R. King
Alfred G. Boyd

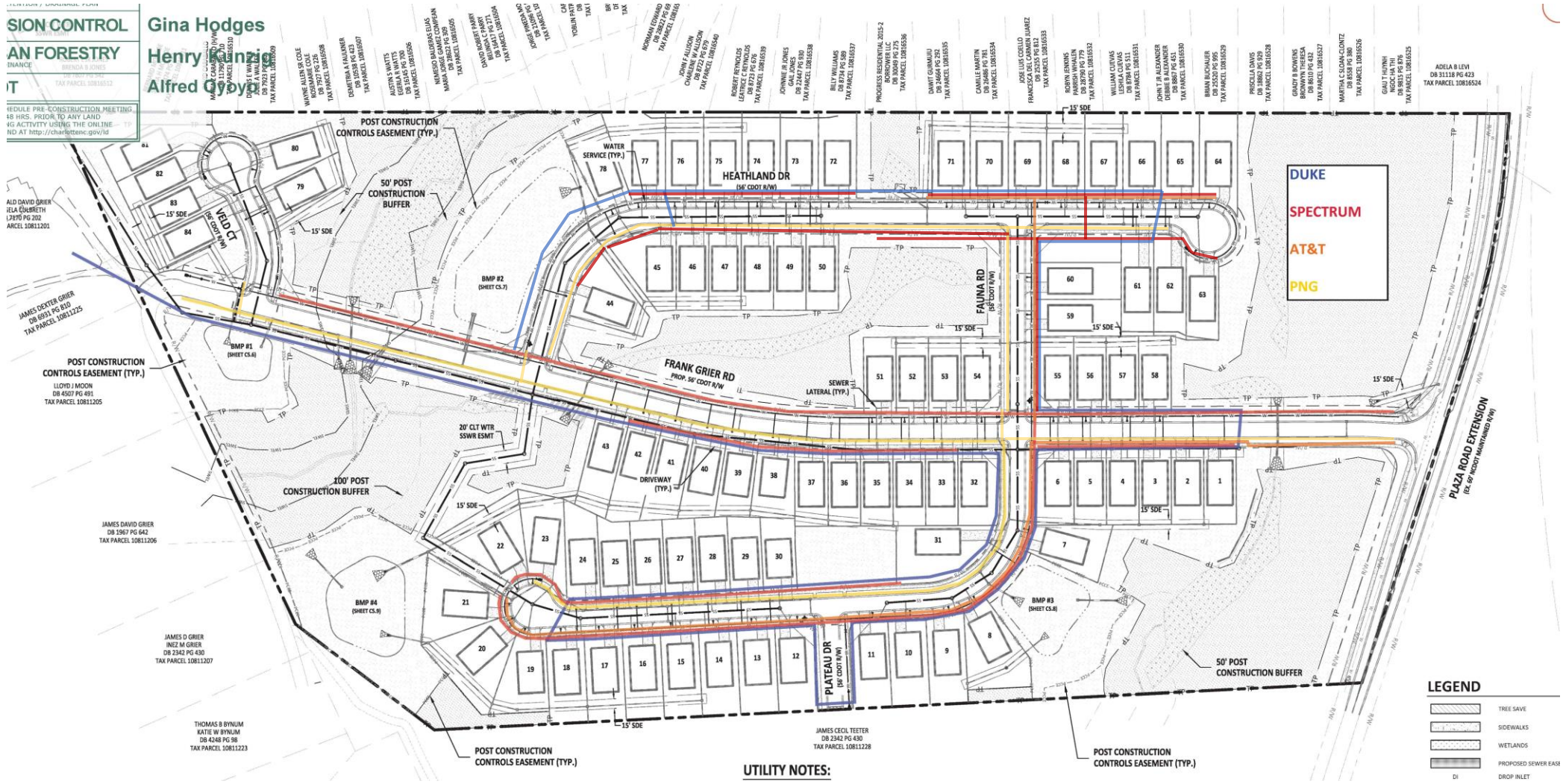

DUKE
SPECTRUM
AT&T
PNG

LEGEND

- TREE SAVE
- SIDEWALKS
- WETLANDS
- PROPOSED SEWER EAST DROP INLET

UTILITY NOTES: